

DRILLS & ACCESSORIES

PORTABLE MAGNETIC DRILLING UNITS

Model CODE	HFLP-35 D9506	HF-35 D950	HF-30A D9505	HF-750 D9507	
Feed	Type	Manual	Manual	Automatic	Manual
Drilling Capacity Range	mm	12-35	12-35	Auto:12-30 Manual:12-35	12-75
Maximum Thickness	mm	35	50	50	50
Suits Cutter Shank Size	mm	19	19	19	19
No. of Drilling Speeds		1	1	1	4
Full Load Drilling Speeds	rpm	390	350	350	90, 120, 180, 230
No Load Drilling Speeds	rpm	650	620	620	150, 200, 300, 380
Magnetic Holding	kg/f	1500	1529	1529	3263
Motor Power	W	1100	1100	1100	1800
Motor Voltage	V	240	240	240	240
Weight	kg	10	14	14	24.8
PRICE	inc GST	\$957	\$990	\$1,749	\$1,815

Includes

- ✓ Chip Guard (HFLP-35)
- ✓ Safety Chain (HF-35/30A/750)
- ✓ Coolant Tank Kit (HF-35/30A/750)
- ✓ Blow Mould Plastic Case

- ✓ CE approved
- ✓ Compact design
- ✓ Heavy duty magnet



HFLP-35

- Compact design
- Quick release handle, left or right hand
- LED work light
- Safety strap



HF-35

- Includes Ø12mm drill chuck & adaptor



HF-30A

- Semi automatic feed (3-speed)



HF-750

- 3MT spindle with broach cutter adaptor
- Forward/reverse tapping
- Ø75mm drilling capacity through 50mm plate

BENCH & PEDESTAL DRILLING MACHINES

- Drilling machines include: Safety micro switch on pulley guard, drill chuck & arbor

- 1hp 240V motor
- 12-speed 2MT
- 16mm drill capacity
- A Section belt drive



- 1hp 240V motor
- 12-speed 2MT
- 20mm drill capacity
- A Section belt drive



- 1hp 240V motor
- 12-speed 3MT
- 28mm drill capacity
- A Section belt drive



PD-325 PEDESTAL
\$385
inc gst D592

BD-325 BENCH
\$352
inc gst D590

PD-360 PEDESTAL
\$495
inc gst D596

BD-360 BENCH
\$440
inc gst D594

PD-440 PEDESTAL
\$792
inc gst D598

PD-35 PEDESTAL
\$1,485
inc gst D162

- 1hp 240V motor
- 9-speed 3MT
- 31.5mm drill capacity
- B-Section belt drive

GEARED HEAD DRILLS

GHD-22

- 31.5mm drilling capacity
- 8 spindle speeds
- 3MT spindle taper
- 350 x 500mm work table rotates 360°
- Drilling depth stop setting with scale
- Rack & pinion table height adjustment with locking lever
- Drill ejector lever
- 1.2hp 415V motor
- Includes: 16mm keyed drill chuck and arbor, chuck key to suit, drill drift tool to remove drill chuck or taper shank drills & safety chuck guard



\$2,365
inc gst D170

GEARED HEAD 31.5mm CAP.

GHD-32

- 40mm drilling capacity
- 12 spindle speeds (95-3200rpm)
- Tapping function
- 4MT spindle with 75mm diameter quill
- 490 x 460mm work table
- Tilting / swivel head ±90°
- 1.5kW / 2hp 415V motor
- Includes: Coolant pump system, drill chuck & arbor, chuck key, drill drift tool, safety chuck guard & drawbar



\$3,245
inc gst D177

GEARED HEAD 40mm CAP.

DMF-42

- Geared head mill drill with 3MT spindle
- 6 spindle speeds ((95-1600rpm)
- Milling table travels 370 x 175mm
- Tilting head ±90°
- Draw bar for milling
- 1.5hp, 240V motor, 6 speeds (95-1600rpm)
- Travels:
(X) 370mm
(Y) 175mm
(Z) 780mm



\$2,739
inc gst D181A

GEARED HEAD & TILTING HEAD

DRILL CHUCK ARBORS

- Precision ground and tapered



Capacity	CODE	inc GST
2MT x JT2	D4412	\$13.20
2MT x JT6	D442	\$17.05
2MT x JT3	D442A	\$17.05
3MT x JT6	D443	\$22.00
3MT x JT3	D443A	\$22.00
3MT x JT4	D455	\$30.25
4MT x JT6	D454	\$30.25
4MT x JT3	D454A	\$30.25
4MT x JT4	D456	\$30.25

MT SLEEVES

- Hardened and precision ground



Capacity	CODE	inc GST
2MT x 1MT	D420	\$12.10
3MT x 2MT	D422	\$18.15
4MT x 2MT	D423	\$24.20
4MT x 3MT	D424	\$26.40
5MT x 4MT	D425	\$58.30

KEYED DRILL CHUCKS - HEAVY DUTY

- Robust design
- Supplied with chuck key

Capacity	Taper	CODE	inc GST
0.5-13mm	JT6	C289	\$59.40
0.5-16mm	JT3	C290	\$82.50



KEYLESS DRILL CHUCKS - INDUSTRIAL

- Superior gripping
- Precision manufactured

Capacity	Taper	CODE	inc GST
0.3 - 13mm	JT6	C292	\$108.90
3-16mm	JT3	C294	\$133.10



DRILLING VICES

V126



V114



Size	Type	CODE	inc GST
100mm	Standard	V124	\$30.25
127mm	Standard	V125	\$42.35
152mm	Standard	V126	\$54.45
100mm	Tilting	V114	\$83.60

DELUXE - DRILL PRESS VICE

- Manufactured from close grain cast iron
- The Deluxe Vice comes with jaws that are hardened with vertical & horizontal grooves for prismatic work



Size	CODE	inc GST
100mm	V144	\$86.90

COMPOUND DRILL VICES

- Cast iron body
- Adjustable slides

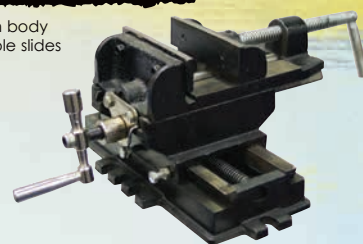

Size	Travel	CODE	inc GST
105mm	114 x 102mm	V120	\$95.70
150mm	203 x 152mm	V122	\$145.20

GRAVITY FEED COOLANT SYSTEM

- CB-2
- 1 litre bottles
- Easily mounted to the side of your machine
- Second bottle that can be mounted underneath a drill or mill table and recovers the coolant



CODE	inc GST
P220	\$29.70

REVERSIBLE TAPPING CHUCKS

- Suitable for all drilling and milling machines for small production runs
- Cushioned drive prevents thread distortion & cross threading

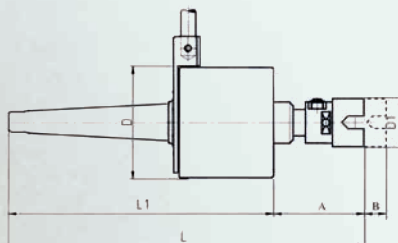

UNITS (mm)

Model	Tapping	Taper	D	D1	L	L1	A	B	Weight kg	CODE	inc GST
K2-2MT	5-10mm	2MT	95	34	230	165	65	11	2.3	T002	\$181.50
K3-3MT	6-14mm	3MT	117	38	270	195	75	13	4.5	T003	\$211.75



2MT
T002

DRILL DRIFTS - FULLY HARDENED

Capacity	Length	CODE	inc GST
2MT x 3MT	140mm	D415	\$9.90
3MT x 4MT	160mm	D416	\$13.20
4MT x 5MT	170mm	D417	\$20.35



DRILL SHARPENER

- EDBD-13
- Tough plastic construction
- Single chuck holding system
- Grinds two flute drills of unlimited length
- Split point operations
- 118° Angle



Model	Capacity	Uses	Weight	CODE	inc GST
EDBD-13	3-13mm	Single Chuck	5kg	D070	\$119.90

OPTIONAL ACCESSORIES - FOR PORTABLE MAGNETIC DRILLING UNITS

- BROACH CUTTERS - HSS
- 19mm weld-on type shank

25mm drill length			50mm drill length		
SIZE	CODE	inc GST	SIZE	CODE	inc GST
12mm	D9512	\$38.50	14mm	D9550	\$44.55
13mm	D9513	\$38.50	16mm	D9552	\$47.30
14mm	D9514	\$38.50	18mm	D9554	\$50.60
16mm	D9516	\$38.50	20mm	D9556	\$59.40
17mm	D9517	\$38.50	22mm	D9558	\$66.55
18mm	D9518	\$38.50	24mm	D9560	\$71.50
20mm	D9520	\$42.35	25mm	D9562	\$78.65
22mm	D9522	\$48.40	26mm	D9564	\$78.65
23mm	D9523	\$48.40	28mm	D9566	\$84.70
24mm	D9524	\$54.45	30mm	D9568	\$90.75
25mm	D9525	\$56.65	32mm	D9570	\$95.70
26mm	D9526	\$56.65	34mm	D9572	\$102.85
28mm	D9528	\$59.40	35mm	D9574	\$107.80
30mm	D9530	\$62.70			
32mm	D9532	\$66.55			
34mm	D9534	\$71.50			
35mm	D9535	\$73.70			

Broach Drill Set - 6 Piece

- High speed steel
- 14, 16, 18, 20, 22 & Ø24mm
- 25mm depth of cut
- 19mm shank size
- 1 x 6.35mm (1/4") locating pin



\$235.95
inc gst
D109

- 13mm Drill Chuck & Adaptor
- Suits Models: HF-35 & HF-30A
- 13mm Drill Chuck with Chuck Key



- 35mm Quick Release Chuck Broach - Cutter Adaptor
- Suits Models: HF-35 & HF-30A
- Suits 19mm shank broach drill cutters



\$107.80
inc gst
D9504

TM TOOLMASTER