

LATHES & ACCESSORIES

BENCH LATHES

AL-51G

- 230 x 500mm turning capacity
- 20mm spindle bore
- Quick change gearbox
- 6 spindle speeds 100-1800rpm
- 0.55kW / 0.75hp, 240V motor

\$1,595

inc gst
L160

ST-51G LATHE STAND

\$319

inc gst
L263

**10mm TOOL
HEIGHT TO SUIT**

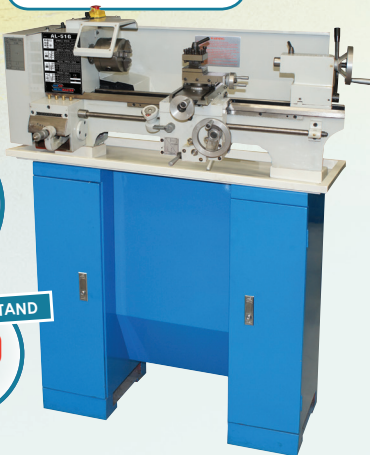

AL-250G

- 250 x 500mm turning capacity
- 26mm spindle bore
- 12 spindle speeds (80 - 1600rpm)
- Quick action gearbox
- 0.75kW / 1hp, 240V motor

\$2,189

inc gst
L149

ST-250G LATHE STAND

\$319

inc gst
L150

**16mm TOOL
HEIGHT TO SUIT**



AL-320G

- 320 x 600mm turning capacity
- 38mm spindle bore
- Geared headstock
- 12 spindle speeds (60 - 1600rpm)
- 0.75kW / 1hp, 240V motor

\$2,695

inc gst
L141

ST-320G LATHE STAND

\$319

inc gst
L142

**12mm TOOL
HEIGHT TO SUIT**



AL-335F

- 300 x 910mm turning capacity
- 38mm spindle bore
- Quick action gearbox
- 9 spindle speeds (75 - 1400rpm)
- 1.5kW / 2hp, 240V motor

\$4,235

inc gst
L681

**STAND
INCLUDED**

**12mm TOOL
HEIGHT TO SUIT**



DELUXE CENTRE LATHE

AL-336D

- 300 x 900mm capacity
- 2-Axis digital readout
- Hardened & ground bed
- 38mm spindle bore
- 1.5kW / 2hp 240V motor
- Includes: 3 & 4-jaw chucks, faceplate, dead centres, work light, steadies, foot brake, splash tray & stand

\$5,225

inc gst
L682D

**STAND
INCLUDED**

**12mm TOOL
HEIGHT TO SUIT**



CENTRE LATHE

AL-356

- 356 x 1000mm capacity
- 2-Axis digital readout
- Hardened & ground bed
- 51mm spindle bore
- 1.8kW / 2.4hp 415V motor
- Includes: 3 & 4-jaw chucks, faceplate, dead centres, work light, steadies, slide out front swarf tray & stand

\$7,425

inc gst
L546E

**STAND
INCLUDED**

**16mm TOOL
HEIGHT TO SUIT**

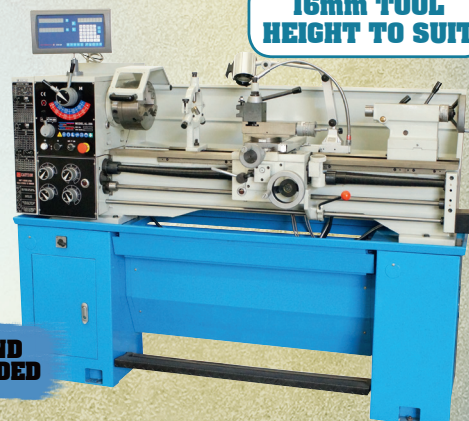

TURNING TOOL KITS TM TOOLMASTER

	12mm	16mm	20mm	25mm
	Package Code Turning Tool (Right Hand) Turning Tool (Left Hand) Boring Bar (Right Hand) Inserts (Pack of 10) Suits all tools TCMT110204 inc GST	Package Code Turning Tool (Right Hand) Turning Tool (Left Hand) Boring Bar (Right Hand) Inserts (Pack of 10) Suit all tools TCMT110204 inc GST	Package Code Turning Tool (Right Hand) Turning Tool (Left Hand) Boring Bar (Right Hand) Inserts (Pack of 10) WNMG080408 inc GST	Package Code Turning Tool (Right Hand) Turning Tool (Left Hand) Boring Bar (Right Hand) Inserts (Pack of 10) WNMG0804 inc GST
	L453 \$290.40	L450 \$314.60	L451 \$390.50	L452 \$423.50

PARTING TOOL KITS TM TOOLMASTER

- 1 x Key insert remover
- 1 x Hex key



	12mm	16mm	20mm	25mm
Package Code 1 x 12mm Parting block 1 x 26 x 2mm Parting blade 2 x 2.2mm Parting inserts inc GST	L464 L027 L468 L0512 \$205.70	Package Code 1 x 16mm Parting block 1 x 26 x 2mm Parting blade 2 x 2.2mm Parting inserts inc GST	Package Code 1 x 20mm Parting block 1 x 26 x 3mm Parting blade 2 x 3mm Parting inserts inc GST	Package Code 1 x 25mm Parting block 1 x 32 x 3mm Parting blade 10 x 3mm Parting inserts inc GST
	L464 \$205.70	L465 \$205.70	L466 \$205.70	L467 \$339.90

THREADING TOOL KITS TM TOOLMASTER



	12mm	16mm	20mm	25mm
Package Code Internal Threading Tool External Threading Tool 1 x 55° 16ERM Insert 1 x 55° 16IRM Insert 1 x 60° 16ERM Insert 1 x 60° 16IRM Insert inc GST	L456 L036 L031 L055 L057 L056 L058 \$229.90	Package Code Internal Threading Tool External Threading Tool 1 x 55° 16ERM Insert 1 x 55° 16IRM Insert 1 x 60° 16ERM Insert 1 x 60° 16IRM Insert inc GST	Package Code Internal Threading Tool External Threading Tool 1 x 55° 16ERM Insert 1 x 55° 16IRM Insert 1 x 60° 16ERM Insert 1 x 60° 16IRM Insert inc GST	Package Code Internal Threading Tool External Threading Tool 1 x 55° 16ERM Insert 1 x 55° 16IRM Insert 1 x 60° 16ERM Insert 1 x 60° 16IRM Insert inc GST
	L457 \$229.90	L457 \$229.90	L458 \$242	L459 \$275

BORING BAR SET

- Carbide Insert**
- 3 x Boring bars in set (8, 10, 12mm)
 - 3 x Inserts • Aluminium case (Re-Order Inserts: L060)



\$169.40
inc gst
L431

TM TOOLMASTER

- Carbide Insert**
- 4 x Boring bars in set (8, 10, 12, 16mm)
 - 10 x inserts (Re-Order Inserts: L060)



\$330
inc gst
L430

LATHE TURNING TOOL KIT

- 5-piece 10mm Tool kit
- 4 x Turning tools
- Re-Order Inserts: TCMT110204 (L062)
- 1 x Boring Bar
- Re-Order Inserts: TCMT090204 (L0615)



\$107.80
inc gst
L0055

LATHE TURNING TOOL KIT

- Turning Tool Set 12mm**
- 7 pieces
 - 1 x right hand parting
 - 1 x Threading Tool
 - 1 x right hand roughing turning tool
 - 1 x left hand & right hand 90° turning tool
 - 1 x straight profile turning tool
 - 1 x right hand profile turning tool
 - 1 x Insert per tool (Re-Order Inserts: L0098)



\$217.80
inc gst
L0099

- Turning Tool Set 16mm**
- 7 pieces
 - 1 x right hand roughing turning tool
 - 1 x right & left hand 90° turning & facing tool
 - 1 x right & left hand profile tool
 - 1 x parting & threading tool
 - Includes 1 x insert per tool



\$229.90
inc gst
L0077

- Carbide Inserts - Replacement Set**
- General Purpose



L0098

Replacement Tip Sets

Suits	Suits Kit	Piece	CODE	inc GST
12mm	L009	9	L009A	\$54.45
16mm	L007	7	L007A	\$78.65
12mm	L0099	10	L0098	\$114.95
16mm	L0077	10	L0078	\$121.00
20mm	L011	7	L011A	\$66.55

ISO TUNGSTEN CARBIDE INSERTS

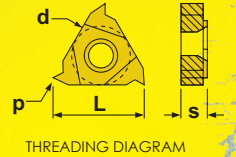
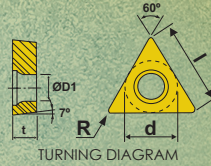

Turning Inserts (Pack of 10)

Type	Grade	l	d	t	R	ØD1	CODE	inc GST
CCMT 060204-GK	CA525	6.5	6.35	2.38	0.4	2.8	L060	\$102.85
CCMT 9T304-GK	CA525	9.7	9.52	3.97	0.4	4.4	L060A	\$132.00
TCMT 090204-HQ	CA525	9.0	5.56	2.38	0.4	2.8	L0615	\$96.80
TCMT 110204-HQ	CA525	11.0	6.35	2.38	0.4	2.8	L062	\$95.70
TCMT 16T304-HQ	CA525	16.5	9.35	3.97	0.4	4.1	L054	\$133.10
TPMR 110304	CA525	11.0	6.35	3.18	0.4	-	L061	\$95.70
TPMR 160308	CA525	16.5	9.52	3.17	0.8	-	L063	\$107.80
TNMG 160404-HQ	CA515	16.5	9.525	4.76	0.4	3.81	L0644	\$119.90
TNMG 160408-PS	CA525	16.5	9.525	4.76	0.8	3.81	L064	\$108.90
TNMG 160408-MS	CA6525	16.5	9.525	4.76	0.8	3.81	L0648	\$119.90
CNMG 120408-PS	CA525	12.7	12.7	4.76	0.8	5.16	L0602	\$139.15
WNMG 080408-PS	CA525	8.7	12.7	4.76	0.8	5.16	L053	\$133.10
WNMG 080404-HQ	CA515	8.7	12.7	4.76	0.4	5.16	L0534	\$133.10
WNMG 080408-MS	CA6525	8.7	12.7	4.76	0.8	5.16	L0538	\$133.10

Threading Inserts (Pack of 5)

Type	L	s	d	Pitch	TPI	CODE	inc GST
11ERM 55° External	11	3.18	6.35	-	48-14	L0545	\$72.60
11ERM 60° External	11	3.18	6.35	0.5-1.75	48-14	L0546	\$72.60
16ERM 55° External	16.5	3.67	9.52	-	48-8	L055	\$90.75
16ERM 60° External	16.5	3.67	9.52	0.5-3.0	48-8	L056	\$90.75
16IRM 55° Internal	16.5	3.67	9.52	-	48-8	L057	\$90.75
16IRM 60° Internal	16.5	3.67	9.52	0.5-3.0	48-8	L058	\$90.75

Parting Inserts - Kennametal (Pack of 10)

Type	Grade	Length	Width	CODE	inc GST
A2022 N00CR02	KC5025	11mm	2.2mm	L0512	\$119.90
A2030 N00CR02	KC5025	11mm	3mm	L0513	\$119.90

HIGH SPEED STEEL BITS



Square Bits

Tool Bit Size	No. Pieces	CODE	inc GST
1/8" SQ x 2 1/2" long	3 Piece	L0001	\$13.20
3/16" SQ x 2 1/2" long	3 Piece	L0002	\$15.95
1/4" SQ x 2 1/2" long	3 Piece	L0003	\$18.15
5/16" SQ x 2 1/2" long	3 Piece	L0004	\$20.35
3/8" SQ x 3" long	2 Piece	L0005	\$22.00
1/2" SQ x 4" long	1 Piece	L0006	\$19.25

Part Off Blades

- 5% Cobalt Parting Blade

H	B	L	CODE	inc GST
1/2"	3/32"	4"	L0007	\$22.00
5/8"	3/32"	5"	L0116	\$32.45

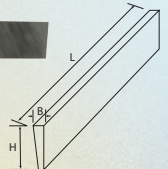

LATHE TURNING TOOL HOLDERS



- Made from high grade steel
- Case-hardened & ground
- Available in straight (S), right (R) and left (L) hand shanks
- NOTE: HSS Tool bits not supplied. Uses Tool Bit L0003



Right



Left



Straight

Shank Size (W x H)	Tool Bit Cap. (inch/mm)	Style	Hand	CODE	inc GST
9.5 x 22mm	1/4" / 6.3mm	American	Right	L070R	\$42.35
9.5 x 22mm	1/4" / 6.3mm	American	Left	L070L	\$42.35
9.5 x 22mm	1/4" / 6.3mm	American	Straight	L070S	\$42.35

TURNING TOOL SET - HSS



- 4 piece
- 1 x R/H & 1 x L/H tool holder
- 1 x Straight tool holder
- 1 x 3/8" Boring bar
- 2 x 1/8" & 2 x 3/16" tool bits



\$90.75
inc gst
L072

PARTING TOOL HOLDERS

- Case-hardened & ground
- Positive locking ensures longer blade life
- Designed to suit 12mm Tool Height
- NOTE: Parting blade not supplied
- Uses Parting Blade L0007

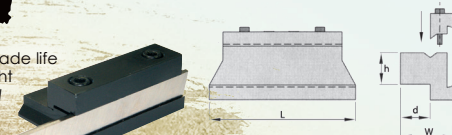

\$59.40
inc gst
L074

Holder Size (mm)	Blade Required
L W H D	
70 34 10 16	1/2" x 3/32" (L0007)

BORING BARS WITH HOLDERS

- Double-ended with 45° & 90° angular square holes
- Supplied fitted with screws & allen key
- NOTE: HSS Tool bits not supplied

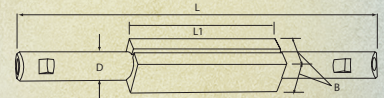
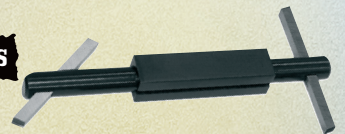

B	D	L	L1	Tool Bit Required	CODE	inc GST
1/2"	3/8"	4 1/2"	2 1/8"	1/8" (L0001)	L100	\$22.00
5/8"	7/16"	5 1/4"	2 1/2"	3/16" (L0002)	L101	\$24.20
3/4"	9/16"	6 3/4"	3"	1/4" (L0003)	L102	\$30.25
1"	3/4"	9"	3 3/4"	5/16" (L0004)	L103	\$42.35
1 1/4"	15/16"	11 1/2"	4 1/2"	3/8" (L0005)	L104	\$47.30

PARTING TOOL HOLDERS

- Case-hardened and ground
- To suit tool steel blades
- Positive locking ensures longer blade life
- Designed to suit 16mm Tool Height
- NOTE: Parting blade not supplied
- Uses Parting Blade L0007

\$42.35
inc gst
L073

Holder Size (mm)	Blade Required
L W H	
125 10 22	1/2" x 3/32" (L0007)



KNURLING TOOL HOLDERS

- Diamond pattern



Shank size (LxWxH)	Knurl Size	Knurling Wheels	Knurl Type	CODE	inc GST
123.6 x 16 x 16mm	19 x 9.5 x 6.3mm	2	Medium	L079	\$42.35
76 x 9.5 x 16mm	19 x 9.5 x 6.3mm	2	Medium	L080	\$83.60
139 x 9.5 x 22mm	16 x 8 x 6.3mm	6	Fine-Medium-Coarse	L070	\$95.70

LIVE CENTRE SETS

- Hardened tip
- Precision ground



MADE IN TAIWAN



Taper	Point Type	CODE	inc GST
2MT	Standard	C050	\$84.70
3MT	Standard	C052	\$96.80
4MT	Standard	C054	\$133.10

Interchangeable Centring Tips Sets

- Body manufactured from SCM-4 tool steel hardened & precision ground
- 7 assorted tips



Taper	Max. RPM	CODE	inc GST
2MT	4500	C062	\$108.90
3MT	4000	C063	\$121.00

Pipe Centres - Bullnose

- The cone has a taper of 70° & is manufactured using CR-MO steel

Taper	Cone Diameter	Code	inc GST
3MT	Ø106mm	C045	\$181.50
4MT	Ø128mm	C046	\$229.90
5MT	Ø156mm	C047	\$330.00



DRILL SETS

5 Piece Industrial Centre Drill Set - HSS

- No. 1, 2, 3, 4, 5
- HSS M2 bright finish
- Industrial quality



\$47.30
inc gst
D508

Precision Jobber Drill Set - HSS

- 51 piece set
- 1-6mm in 0.1mm steps
- HSS M2 precision ground



\$133.10
inc gst
D1285

Metric - 2MT Drill Set

- 100% HSS flute length
- Sizes: 14.5, 15, 16, 17, 18, 19, 20, 21, 22, 23mm



\$217.80
inc gst
D122

Reduced Shank Drill Sets - 8 piece

- High speed steel M2 grade 100% flute length
- 118° point angle

Metric
Range: 13 - 25mm
Shank Ø13mm

\$168.30 inc GST (D1171)

Imperial
9/16" - 1" Range
Shank Ø1/2"

\$168.30 inc GST (D1181)



Industrial Jobber Drill Sets

- Precision ground flutes
- HSS M2 bright finish
- 135° split point centre

25 Piece Metric 1 - 13mm (x 0.5mm)

\$107.80 inc GST (D1272)

29 Piece Imperial 1/16" - 1/2" (x 1/64")

\$114.95 inc GST (D1282)



Industrial Jobber Drill Packs

- Industrial M2 grade high speed steel
- Ground flute & split point
- 135° ground drill point

Ø(mm)	Qty	CODE	inc GST	Ø(mm)	Qty	CODE	inc GST
1.0	10	D8150	\$11.00	7.0	10	D8162	\$55.00
1.5	10	D8151	\$11.00	7.5	10	D8163	\$63.80
2.0	10	D8152	\$11.00	8.0	5	D8164	\$27.50
2.5	10	D8153	\$11.00	8.5	5	D8165	\$31.35
3.0	10	D8154	\$15.95	9.0	5	D8166	\$35.75
3.5	10	D8155	\$15.95	9.5	5	D8167	\$40.15
4.0	10	D8156	\$18.70	10.0	5	D8168	\$44.55
4.5	10	D8157	\$23.10	10.5	5	D8169	\$49.50
5.0	10	D8158	\$28.05	11.0	5	D8170	\$55.55
5.5	10	D8159	\$32.45	11.5	5	D8171	\$61.05
6.0	10	D8160	\$38.50	12.0	5	D8172	\$68.20
6.5	10	D8161	\$46.75	12.5	5	D8173	\$73.70

Knurling Tool Kit

- 12mm centre height at one end & 16mm at the other end
- Interchangeable heads with Medium, Fine & Straight knurls



Centre Height	Head 1	Head 2	Head 3
12 or 16mm	Medium 2 Wheels	Fine 2 Wheels	Straight 1 Wheel

\$107.80
inc gst
L076

3 JAW SELF CENTRING LATHE CHUCK

- Manufactured from cast iron to ISO 9001-2000
- Standard accuracy

TM TOOLMASTER

Standard Back Plate Mount

Size mm	Bar Cap. mm	Ring Cap. mm	Bore mm	Max. RPM	Weight kg	CODE	inc GST
125	2.5-40	38-110	30	3000	6	C202	\$156.20
160	3-55	55-145	45	2500	9	C203	\$204.60
200	4-85	65-200	65	2000	16.8	C205	\$265.10

Camlock Direct Mount

Size mm	Bar Cap. mm	Ring Cap. mm	Bore mm	Max. RPM	Weight kg	Mount	CODE	inc GST
160mm	3-55mm	55-145mm	40mm	2500	10	D1-4	C260	\$275

4 JAW INDEPENDENT LATHE CHUCK

- Back Plate Mount

Size mm	Bore mm	Weight kg	CODE	inc GST
125	30	6	C232	\$126.50
160	45	10	C250	\$181.50



MORSE TAPER SHANK DRILLS

- High Speed Steel
- Made to DIN345 standard

Ø(mm)	Taper	CODE	inc GST	Ø(mm)	Taper	CODE	inc GST
12.5	1MT	D300	\$15.95	22.0	2MT	D319	\$36.30
13.0	1MT	D301	\$18.15	22.5	2MT	D320	\$36.30
13.5	1MT	D302	\$18.15	23.0	2MT	D321	\$38.50
14.0	1MT	D303	\$22.00	23.5	3MT	D322	\$43.45
14.5	2MT	D304	\$22.00	24.0	3MT	D323	\$43.45
15.0	2MT	D305	\$22.00	24.5	3MT	D324	\$43.45
15.5	2MT	D306	\$22.00	25.0	3MT	D325	\$47.30
16.0	2MT	D307	\$22.00	25.5	3MT	D326	\$47.30
16.5	2MT	D308	\$22.00	26.0	3MT	D327	\$50.60
17.0	2MT	D309	\$24.20	26.5	3MT	D328	\$50.60
17.5	2MT	D310	\$24.20	27.0	3MT	D329	\$54.45
18.0	2MT	D311	\$26.40	27.5	3MT	D330	\$54.45
18.5	2MT	D312	\$26.40	28.0	3MT	D331	\$56.65
19.0	2MT	D313	\$26.40	28.5	3MT	D332	\$56.65
19.5	2MT	D314	\$26.40	29.0	3MT	D333	\$60.50
20.0	2MT	D315	\$30.25	29.5	3MT	D334	\$60.50
20.5	2MT	D316	\$30.25	30.0	3MT	D335	\$72.60
21.0	2MT	D317	\$34.10	30.5	3MT	D336	\$72.60
21.5	2MT	D318	\$34.10	31.0	3MT	D337	\$83.60